

- ⊙ Break Glass Point (1200mm affl)
- FD 1 hour fire door with intumescent strips & door closers
- FD1 As FD, held open with magnetic catch linked to fire alarm.
- SD Smoke detector
- 🚒 Fire Alarm Control Panel
- 🔥 Foam fire extinguisher, wall mounted 6 litre capacity unless otherwise stated
- 💧 Water fire extinguisher, wall mounted 9 litre capacity unless otherwise stated
- 🧴 Wet Chemical fire extinguisher.
- 🧯 Fire Blanket

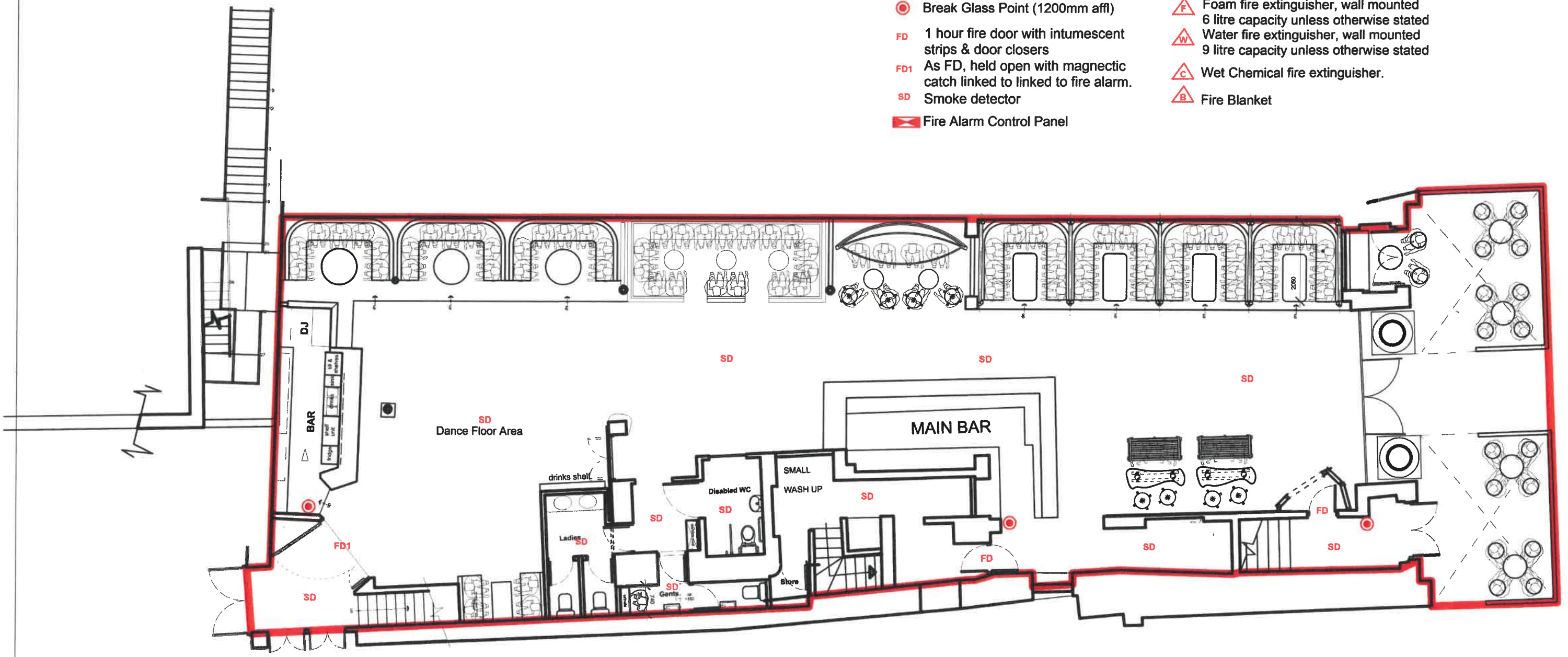

— Extent of Licensed Premises

Notes:
 Licensed Activities may take place anywhere within the red line
 Locations of fire safety and other equipment are indicative only and may change following a fire risk assessment or on the advice of the fire officer
 Any detail not required by regulations is indicative only and subject to change without notice

01 GF Floor Licensing Plan scale 1:100 @ A3



speake design interior architecture & design tel: 0777 585 1350, email: simonpeake@hotmail.com	notes:	rev:	date:	description:	client: Creative HG	scale: 1:100 @ A3	date: 08/06/20	Figured dimensions are to be followed in preference to dimensions scaled from drawings. All dimensions are to be checked on site by contractors and said dimensions are to be their responsibility. Drawing errors and omissions to be reported to the designer. Contractors to con form to all current Building and Planning Regulations and liaise with relevent Local Authority Departments. This drawing is copyright of Speake Design. There is no inferred copyright. Copyright is reserved by them. The drawing is issued on condition that it is not copied or disclosed by or any unauthorized persons without prior consent in writing of - Speake Design.
					project: Bambu	drawing no: BAM AB 12	rev:	
					title: GF Floor Licensing Plan	drawn by: SP		